

# D. D. A.

## DWARKA PROJECT

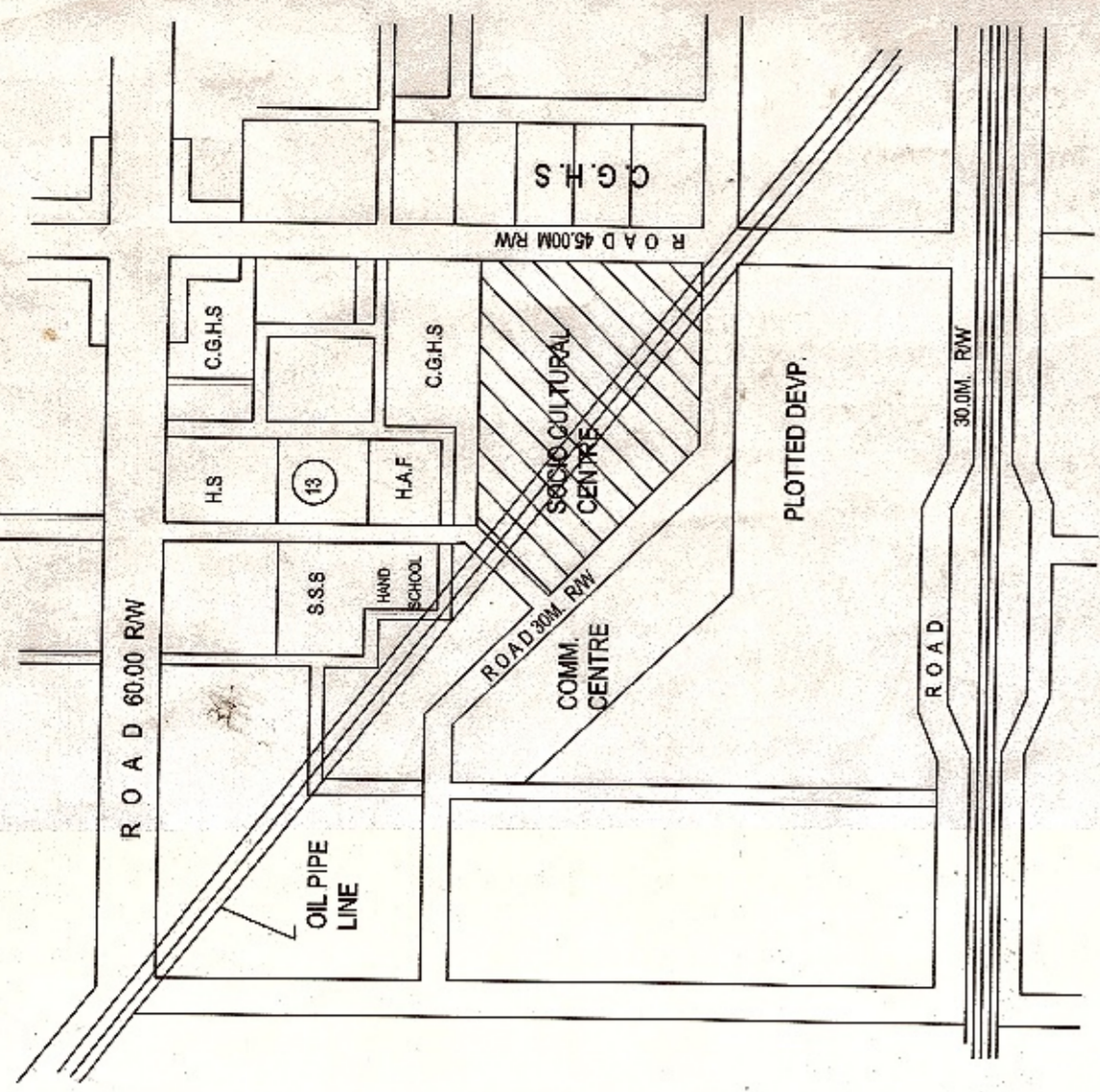

KEY PLAN  
PART SECTOR PLAN -13

### AREA STATEMENT :-

TOTAL SCHEME AREA = 71435.00 SQM.

PLOT NOS.	LAND USES	AREA (IN SQM.)
1	PUBLIC&SEMIPUBLIC FACILITY-VACANTONAL TRAINING CENTRE	20,210.00
4	PUBLIC&SEMIPUBLIC FACILITY-RELIGIOUS AT SUB-CITY LEVEL	8,000.00
2,3 & 7	PUBLIC&SEMIPUBLIC FACILITY-SOCIO-CULTURAL FACILITY	18,164.67
	COMMERCIAL (LSC) & MULTILEVEL PARKING	3,806.00
	ESS 2NOS.	160.00
	RECREATIONAL (INCLUDING ROW)/RESERVATION FOR OIL PIPE LINE	10486.93
	CIRCULATION	10607.40
	<b>TOTAL</b>	<b>71435.00</b>

### NOTES:-

- LAYOUT PLAN WAS APPROVED BY 177N.S.C. COMMITTEE VIDE ITEM NO. 109/96/177 DATED 25/6/96.
- EA/MD-6 VIDE NO. F27(1)SMB-8/DDA/464 DATED 15/6/2011 INTIMATED THAT SERVICES AND ROADS ARE NOT LAID IN SOCIO CULTURAL CENTRE AT SECTOR 13, DWARKA.
- EA/MD-6 DDA VIDE NO. F4(6) AE/PI/DANIL DATED 19/2011 PROVIDED TOTAL STATION SURVEY.
- 0.80 HAC PLOT FOR ISKON TEMPLE PROPOSED WITH REFERENCE TO DECISION OF THE AUTHORITY ON 28/7/2011 VIDE ITEM NO. 66/2011.
- THE DEVELOPMENT CONTROL NORMS WILL BE AS PER MASTER PLAN FOR DELHI.
- THE PROPOSAL APPROVED BY VICE CHAIRMAN DDA ON 12.08.2011 IN FILE NO. F-4(13) 2011/PLG/DWK. AT PAGE NO.12N

### REVISED LAYOUT PLAN FOR SOCIO-CULTURAL CENTRE SECTOR-13

SCALE: 1:500  
DW/SEC/USDC/REPL/SEP/2011/180  
BRG. NO. :-  
DATE: SEPT 2011  
P.L.G. ASST.  
ASST. DIRECTOR (P.L.G.)  
BY: DIRECTOR (P.L.G.)  
DIRECTOR (P.L.G.)

### DELHI DEVELOPMENT AUTHORITY

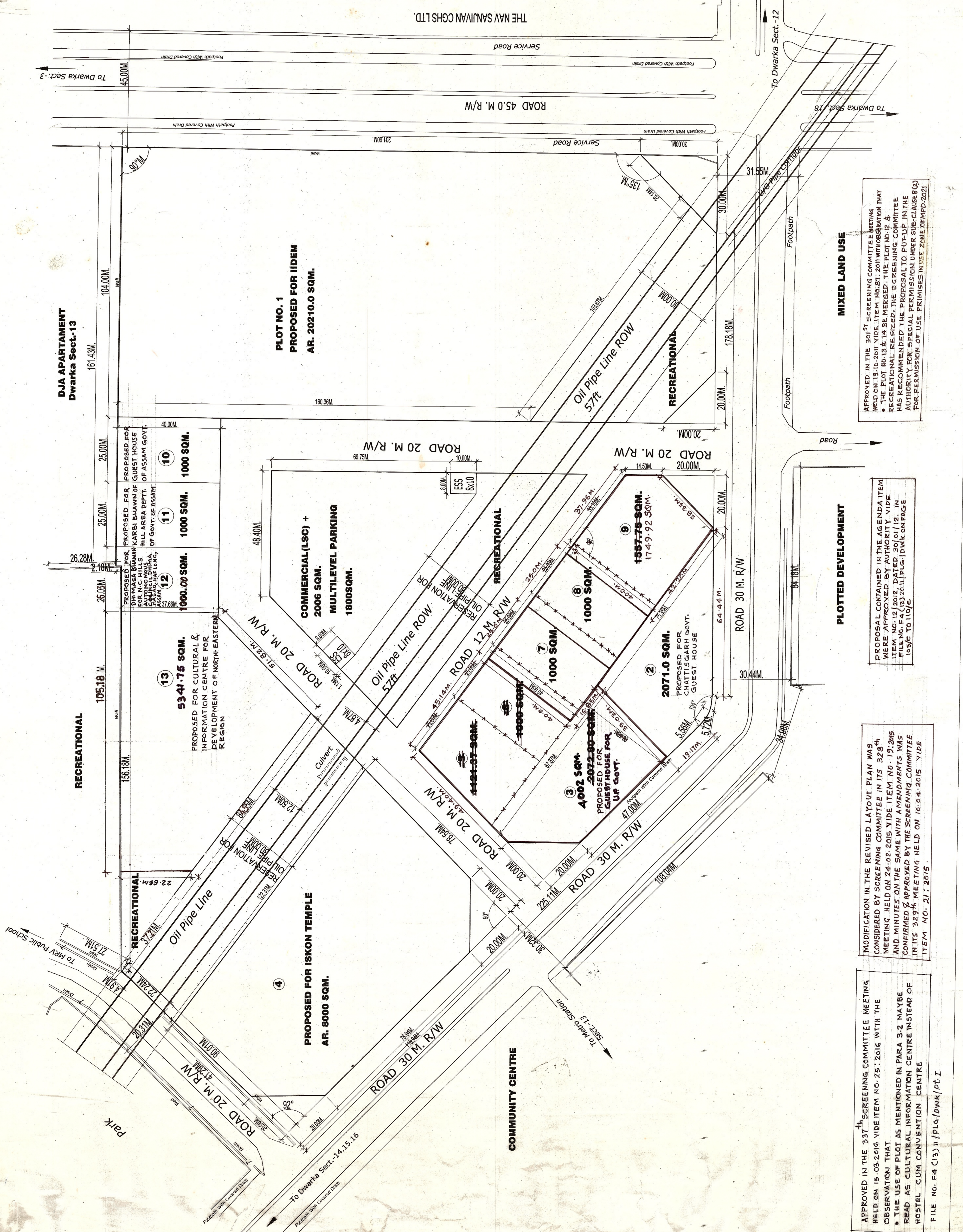

**MIXED LAND USE**  
APPROVED IN THE 304<sup>TH</sup> SCREENING COMMITTEE MEETING HELD ON 19.10.2011 VIDE ITEM NO. 87/2011 WITH OBSERVATION THAT THE PLOT NO. 13 & 14 BE MERGED. THE PLOT NO. 12 & 13 RECREATIONAL. RECOMMENDED BY THE GREENING COMMITTEE. HIS RECOMMENDATION THE PROPOSAL TO PUT-UP IN THE MIXED LAND USE FOR SPECIAL PERMISSION UNDER SUB-CLAUSE (2) FOR PERMISSION OF USE PREMISES IN USE ZONE OF MPD-2021.

**PLOTTED DEVELOPMENT**  
PROPOSAL CONTAINED IN THE AGENDA ITEM WERE APPROVED BY AUTHORITY VIDE ITEM NO. 12/2012, DATED 30/01/12. IN FILE NO. F-4(13) 2011/PLG/DWK ON PAGE 10/12 TO 11/12.

MODIFICATION IN THE REVISED LAYOUT PLAN WAS CONSIDERED BY SCREENING COMMITTEE IN ITS 328<sup>TH</sup> MEETING HELD ON 24.02.2015 VIDE ITEM NO. 19/2015 AND MINUTES ON THE SAME WITH A MENDMENT WAS CONFIRMED & APPROVED BY THE SCREENING COMMITTEE IN ITS 329<sup>TH</sup> MEETING HELD ON 10.04.2015 VIDE ITEM NO. 21/2015.

APPROVED IN THE 337<sup>TH</sup> SCREENING COMMITTEE MEETING HELD ON 19.03.2016 VIDE ITEM NO. 25/2016 WITH THE OBSERVATION THAT THE USE OF PLOT AS MENTIONED IN PARA 3.2 MAYBE READ AS CULTURAL INFORMATION CENTRE INSTEAD OF HOSTEL CDMH CONVENTION CENTRE  
FILE NO. F-4 (13) 11/PLG/DWK/PT I